

REV.	DESCRIPTION	DATE
A	New Drawing	2016/12/13

Single Row

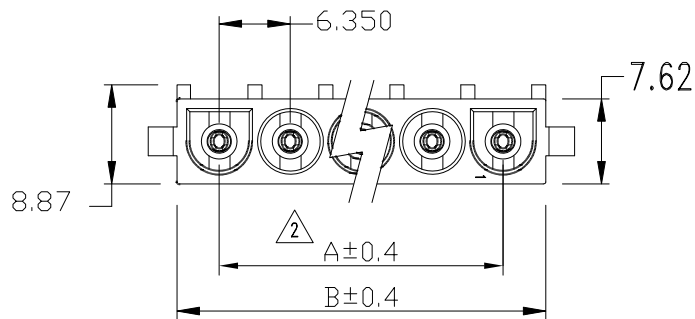

Dimensional Information (mm)

Circuits	Dim. A	Dim. B	Circuits	Dim. A	Dim. B
2	6.35	13.97	7	38.10	45.72
3	12.70	20.32	8	44.45	52.07
4	19.05	26.67	9	50.80	58.42
5	25.40	33.02	10	57.15	64.77
6	31.75	39.37			

Features / Specification:

- Pin Material : Tin-plated phosphor bronze
- Used plastic material PA66 V0 based on UL file no.: E132701
- Current rating: 13A (2~4P), 11A (6~15P)
- Voltage rating: 600V
- Dielectric withstanding voltage: 5000V AC/minute
- Ambient temperature rise: -55℃ ~ 105℃

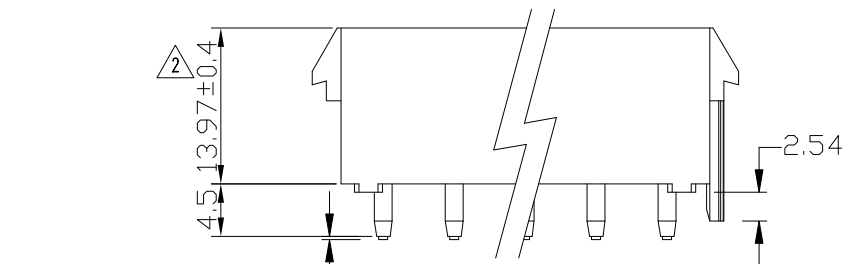

0.25 (Cut off Tab)

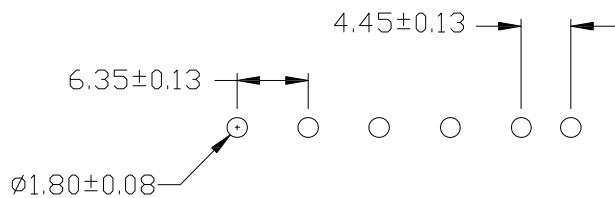

P. C. board layout

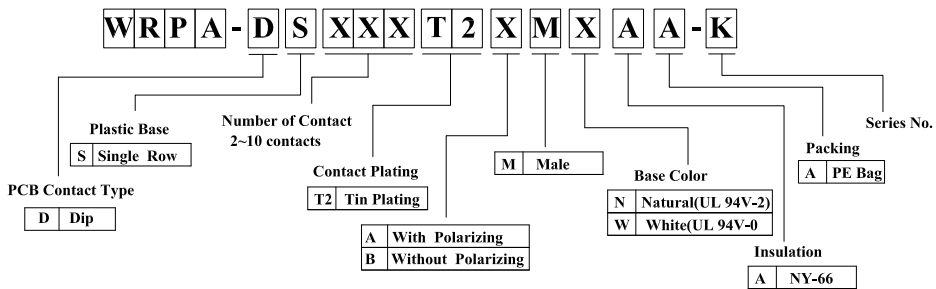

RoHS compliant

竣豪電子股份有限公司
Superior Tech Co., Ltd.

General Tolerance		TITLE	250"(6.35mm) Power Connector	
X. ± 0.5		DRAWN	DATE	NO.
.X ± 0.3		Andy	12-13-16'	T062
.XX ± 0.2		CHECK	DATE	PART NO.
.XXX ± 0.1		APPROVED	DATE	WRPA-DSXXXT2XMXAA-K
角度	± 5°			CUSTOMER NO.

REV.	UNIT	SCALE
A	mm	1:1

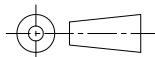

(Q2-R03-01A) ST-R05-07